



InstallerSHOW
YOUR NATIONAL HEATING AND PLUMBING EVENT

RICOH ARENA
COVENTRY
28-30 SEPT 21
installershow.com

InstallerELECTRIC
THE NATIONAL TRADE SHOW FOR ELECTRICAL PROFESSIONALS

RICOH ARENA
COVENTRY
28-30 SEPT 21

CORE PACKAGE

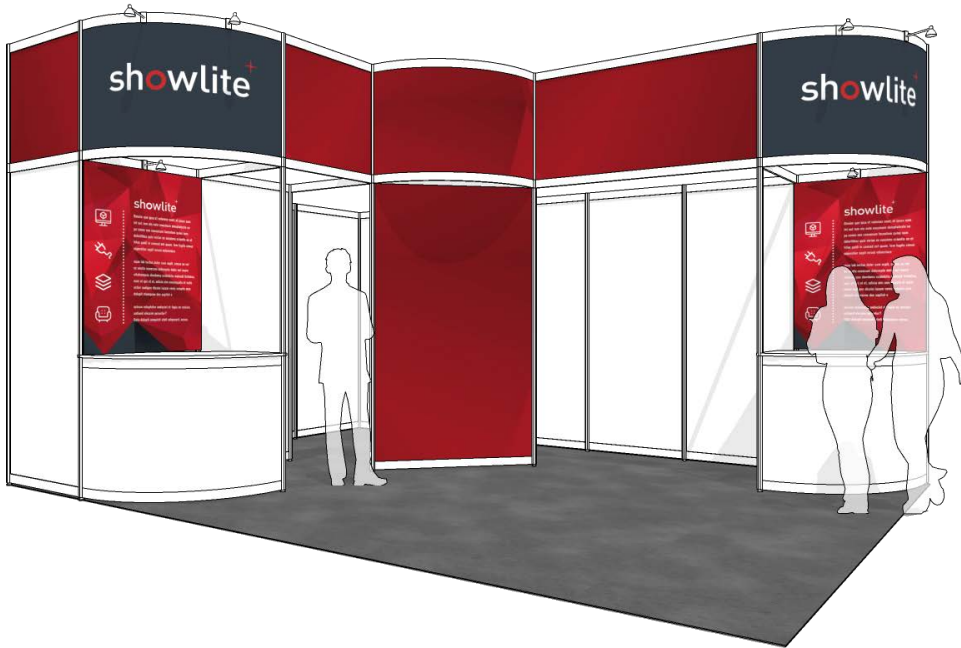

CORE PACKAGE

- Cord Carpet
Choice of 5 Colours - see www.showlitepackages.com/flooring
- 3.5m Overall Height
- White Modular Frame
- White Wall Panels
- 2m x 1m Store with Door
- 2 qty Fascia Curves with Graphic Print
- 1 qty Fascia Curve with Colour Sheet
- Flat Fascia with Colour Sheets
- 1 qty W2 Angled Wall with Colour Sheet

Colour Sheets: Choice of 13 Colours - see www.showlitepackages.com/colour-sheets

- 2 qty D2 White Counters, Black or White Top, Open to Rear
- 2 qty W4 Flush Fitting Graphic Prints to Walls above Counters

£1,930.00 *Excluding recommended Lighting & Sockets*

Recommended Lighting & Sockets :

- 6 qty Long Arm Spotlights (as per CORE Package illustration)
- 2 qty 2Amp 500w Sockets

£2,543.00** *Including recommended Lighting & Sockets*

*** All Lighting & Sockets will be invoiced separately from the CORE Package*

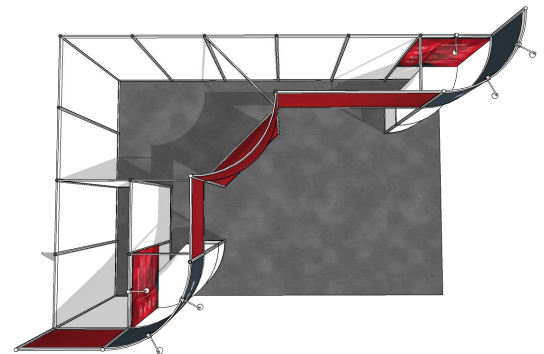
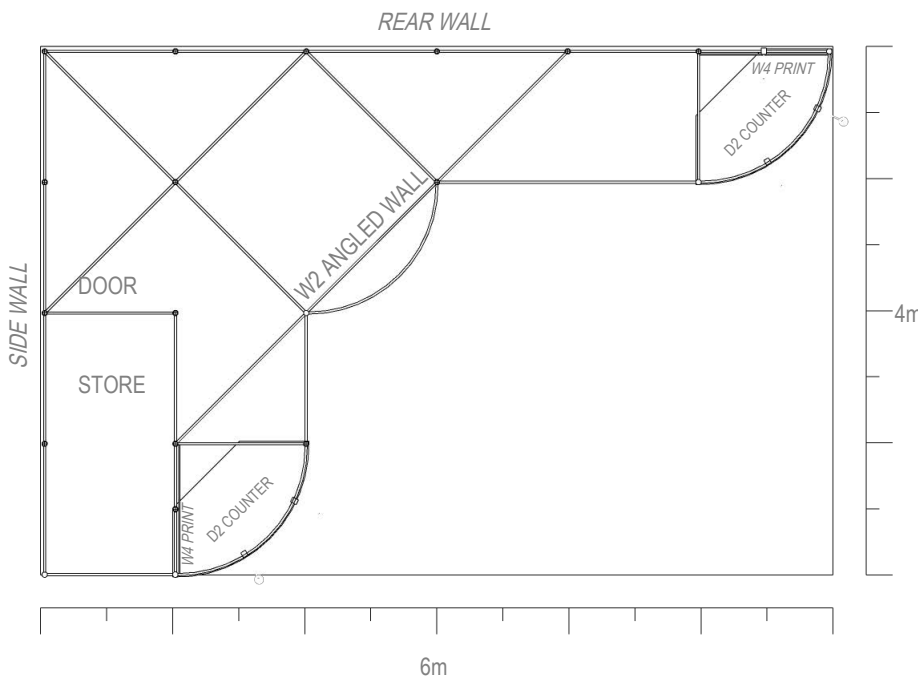

Documents for this Package Range inc:

- 1: SALES FLYER [This document]
- 2: EXPLORE MORE [Visit: www.showlitepackages.com]
- 3: CUSTOMISATION PRICING [Contact Us]

01264 365 550
evolve@showlite.co.uk
www.showlitepackages.com

showlite⁺